

1  
 S1.0 CONCEPTUAL RENDERINGS  
 NTS



2  
 S1.0 VICINITY MAP  
 NTS

INDEX	FABRIC INFO
S1.0 COVER PAGE	FABRIC: ALNET COLOR: TRUE BLUE & MIDNIGHT  POWDER COAT: TBD
S2.0 GENERAL STRUCTURAL NOTES	
S3.0 SITE PLAN	
S4.0 STRUCTURE PLAN	
S5.0 STRUCTURE ELEVATION	
S6.0 DETAILS	
SCOPE OF WORK	
THE CONTRACTOR SHALL MANUFACTURE AND INSTALL ALL MATERIALS NECESSARY FOR THE PROJECT, INCLUDING:	
*INSTALLATION OF SIX (6) ROUND COLUMNS SET IN CONCRETE FOOTINGS, CAPPED AND FINISHED AS AGREED.	
*MANUFACTURE AND INSTALLATION OF TWO (2) CUSTOM SHADE SAILS.	
*SAMPLES AVAILABLE UPON REQUEST.	

COVER PAGE  
 Date: 05/01/2017

**BOYS & GIRLS CLUB PAL ESCONDIDO**  
 PLAY STRUCTURE SHADE SAIL  
 115 WOODWARD AVENUE  
 ESCONDIDO, CA 92025

**S1.0**

**GENERAL STRUCTURAL NOTES**

**APPLY UNLESS NOTED OTHERWISE ON STRUCTURAL DRAWINGS**

**CODE:** Comply with 2012 International Building Code.

**SEISMIC:** I = 1.00; Occupancy Category II  
 Spectral Response Accelerations:  $S_s = 0.179$ ,  $S_1 = 0.0061$ ;  
 Site Classification 'D'  
 Spectral Response Coefficients:  $S_{DS} = 0.191$ ,  $S_{D1} = 0.097$   
 Seismic Design Category: C; Seismic Response Coeff.  $C_s = 0.0535$   
 Response Modification Factor R = 2.50  
 Resisting System: Cantilever Column System with Special Steel Moment Frames.  
 Equivalent Lateral Force Procedure.

**WIND:** Basic wind speed 115 mph; Exposure 'C';  
 I = 1.00; Occupancy Category II  
 Method 2, Open Structures, Pitched Free Roofs (Unobstructed Wind)  
 Gust Effect Factor:  $G = 0.85$ ,  $\Lambda = 1.22$   
 $q_h = 14.98$  psf  
 Components & Cladding Wind Pressures:  
 Zone 1 = -17.78 & + 10.00  
 Zone 2 = -29.72 & + 10.00  
 Zone 3 = -44.82 & + 10.00

**DEAD LOADS:** Roof: 1 psf + Self-weight of Steel Frame

**LIVE LOADS:** Roof: 5 psf

**FOUNDATIONS:**

Footings shall bear on firm undisturbed soil at 1'-6" minimum below natural or finish grade, whichever is lower. Allowable soil bearing 1,500 psf. (Table 1804.2 - Class 5 soils)

**CONCRETE:**

All A.C.I. Codes, recommendations, and manuals apply. Minimum 28 day strength, 2,500 psi. No special inspection required.

**REINFORCING:**

ASTM A-615 Grade 60 except as follows:

All reinforcing bars deformed except #2 and wire mesh. Latest ACI Code and Detailing Manual apply. Place rebar per CRSI Manual. Unless indicated otherwise in details clear concrete cover to any reinforcing including ties is as follows:

Uniformed concrete placed against rough earth	3"
Formed concrete exposed to earth	2"

**LAP SPLICES IN CONCRETE:**

See drawings. Unless noted otherwise, provide the following lap splices: #3 - 16"; #4 - 22"; #5 - 27"; #6 - 35".

**STRUCTURAL STEEL:**

ASTM A-36 (Fy = 36,000 p.s.i. minimum) for miscellaneous steel, ASTM A-500, Grade 'B' (Fy = 46,000 p.s.i. minimum) for all tube members. Bolts and plain anchors ASTM A-307. Latest American Institute of Steel Construction (AISC) Manual and AISC Specifications apply.

**WELDING:**

AWS Codes and recommendations apply. All structural welding to be by certified welders or inspected by qualified party. Welding rods to be low hydrogen type, E70 Series typically except E-6010 Series for sheet steel per AWS D1.3.

**SUPPLEMENTARY NOTES:**

For connections, see detail. If not shown or noted proceed after clarification by the Engineer.

Unless noted otherwise, details on Structural Drawings are typical as indicated by cuts, references, or titles.

Provide all temporary bracing, shoring, guying or other means to avoid excessive stresses and to hold structural elements in place during construction.

Contractor shall establish and verify in field all existing conditions affecting new construction. Contact SHADE Industries immediately if existing conditions are not as depicted in drawings.

**ABBREVIATIONS:**

ALT.	ALTERNATE	LO	LOW CONDITION
ARCH.	ARCHITECTURAL DRAWINGS	LONG.	LONGITUDINAL
BOT.	BOTTOM	MAX.	MAXIMUM
COL.	COLUMN	MECH.	MECHANICAL
CONC.	CONCRETE	MIN.	MINIMUM
CONT.	CONTINUOUS	MISC.	MISCELLANEOUS
DIA./φ	DIAMETER	N.S.	NEAR SIDE
DTL.	DETAIL	O.C.	ON CENTER
E	EXISTING MEMBER/SYSTEM	OPP.	OPPOSITE
EA.	EACH	PL.	PLATE
EMBED.	EMBEDMENT	PREFAB.	PREFABRICATED
E.N.	EDGE NAILING	P/T	POST-TENSIONED
E.S.	EACH SIDE	REINF.	REINFORCEMENT
E.W.	EACH WAY	REQ'D	REQUIRED
F.F.	FINISHED FLOOR	SIM.	SIMILAR
F.G.	FINISHED GRADE	SPECS.	SPECIFICATIONS
F.N.	FIELD NAILING	SQ.	SQUARE
F.S.	FAR SIDE	STD.	STANDARD
GALV.	GALVANIZED	STL.	STEEL
GLB.	GLULAM BEAM	t	THICKNESS (INCHES)
G.S.N.	GENERAL STRUCTURAL NOTES	T.B.	THROUGH BOLTS
HI	HIGH CONDITION	TYP.	TYPICAL
HORIZ.	HORIZONTAL	U.N.O.	UNLESS NOTED OTHERWISE
HSS	HOLLOW STRENGTH STEEL	VERT.	VERTICAL
L.G.S.	LIGHT GAUGE STEEL STUD	W/	WITH

GENERAL STRUCTURAL NOTES  
 Date: 05/01/2017

**BOYS & GIRLS CLUB PAL ESCONDIDO  
 PLAY STRUCTURE SHADE SAIL  
 115 WOODWARD AVENUE  
 ESCONDIDO, CA 92025**

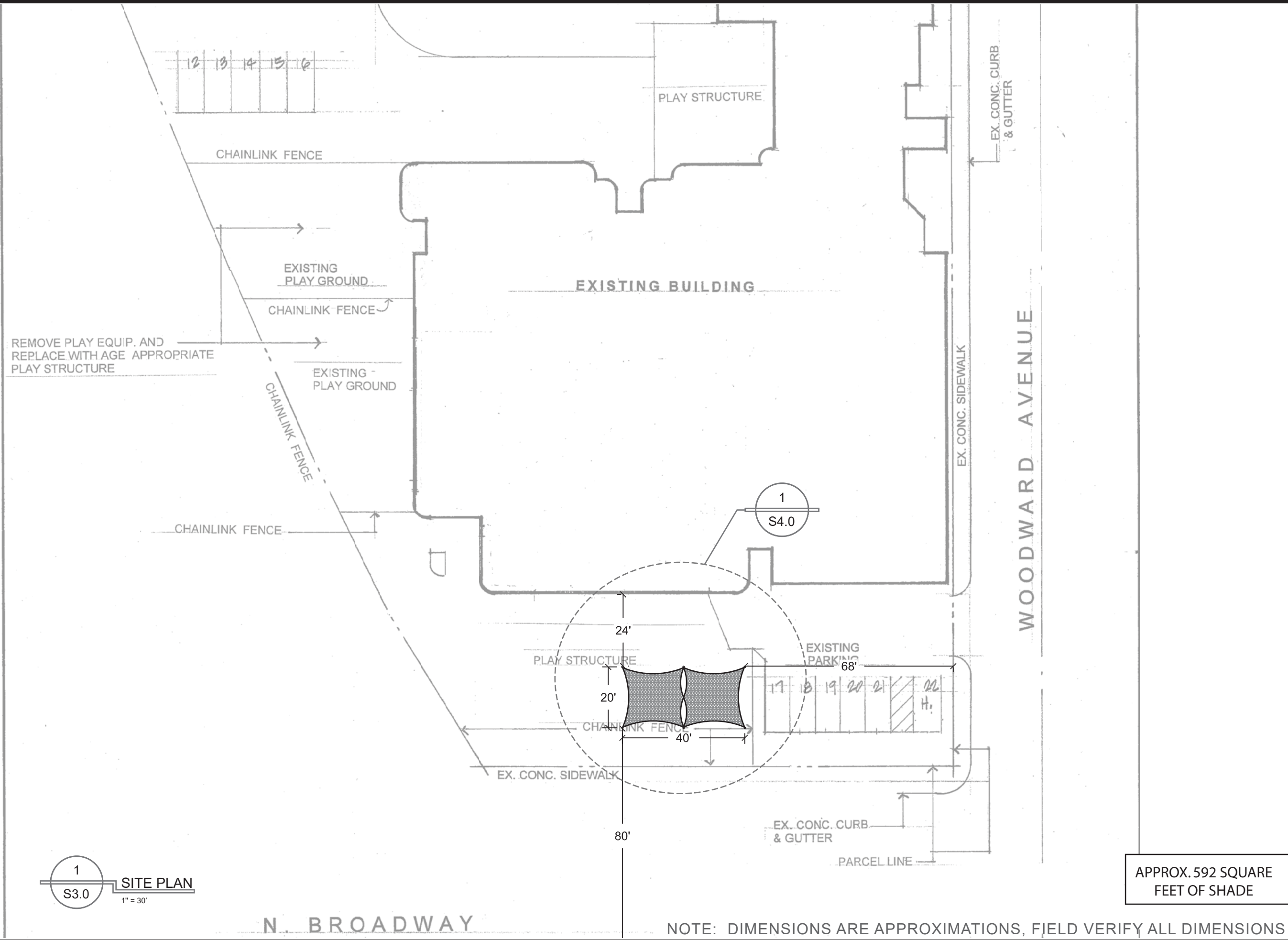

Date: 05/01/2017 SITE PLAN

**BOYS & GIRLS CLUB PAL ESCONDIDO**  
**PLAY STRUCTURE SHADE SAIL**  
 115 WOODWARD AVENUE  
 ESCONDIDO, CA 92025

**S3.0**

APPROX. 592 SQUARE  
 FEET OF SHADE

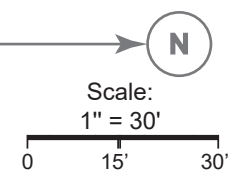

1  
 S3.0  
 SITE PLAN  
 1" = 30'

NOTE: DIMENSIONS ARE APPROXIMATIONS, FIELD VERIFY ALL DIMENSIONS

PLAY STRUCTURE

EXIS  
 PAR

COLUMN 1: 12'-2"  
 SAIL 1: 12'-0"

COLUMN 2: 12'-2"  
 SAIL 2: 12'-0"  
 SAIL 1: 8'-0"

COLUMN 3: 8'-2"  
 SAIL 2: 8'-0"

1a,b  
 S6.0  
 TYP.

2  
 S6.0

CHAINLINK FENCE

COLUMN 6: 8'-2"  
 SAIL 1: 8'-0"

COLUMN 5: 12'-2"  
 SAIL 1: 12'-0"  
 SAIL 2: 8'-0"

COLUMN 4: 12'-2"  
 SAIL 2: 12'-0"

EX. CONC. SIDEWALK

APPROX. 592 SQUARE  
 FEET OF SHADE

1  
 S4.0  
 STRUCTURE PLAN  
 1/8" = 1'

NOTE: DIMENSIONS ARE APPROXIMATIONS, FIELD VERIFY ALL DIMENSIONS  
 NOTE: ALL HEIGHTS CALLED OUT ABOVE PATIO GRADE  
 NOTE: COLUMNS OUT OF PLUMB AS DETERMINED APPROPRIATE BY INSTALLER

Date: 05/01/2017  
 STRUCTURE PLAN

BOYS & GIRLS CLUB PAL ESCONDIDO  
 PLAY STRUCTURE SHADE SAIL  
 115 WOODWARD AVENUE  
 ESCONDIDO, CA 92025

S4.0

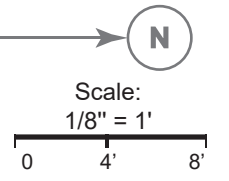



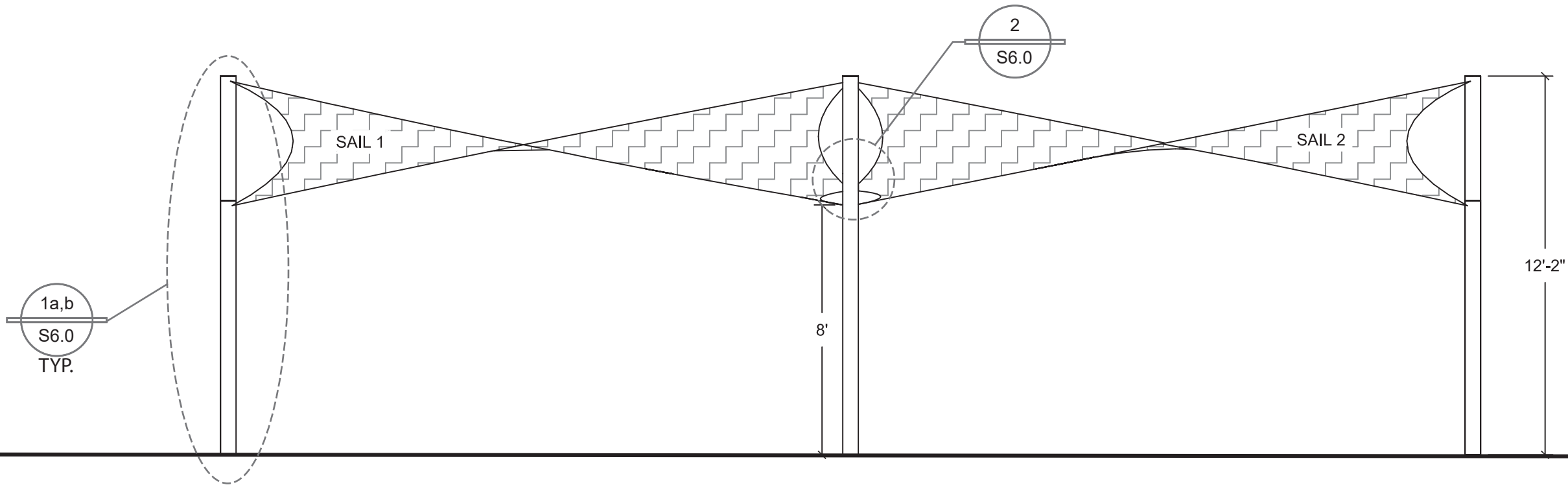

Date: 05/01/2017  
 ELEVATION

**BOYS & GIRLS CLUB PAL ESCONDIDO**  
 PLAY STRUCTURE SHADE SAIL  
 115 WOODWARD AVENUE  
 ESCONDIDO, CA 92025

**S5.0**

1  
 S5.0  
 STRUCTURE ELEVATION  
 1/4" = 1'

NOTE: DIMENSIONS ARE APPROXIMATIONS, FIELD VERIFY ALL DIMENSIONS  
 NOTE: ALL HEIGHT CALLED OUT ABOVE PATIO GRADE  
 NOTE: COLUMNS OUT OF PLUMB AS DETERMINED APPROPRIATE BY INSTALLER

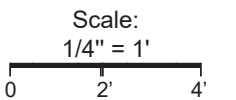

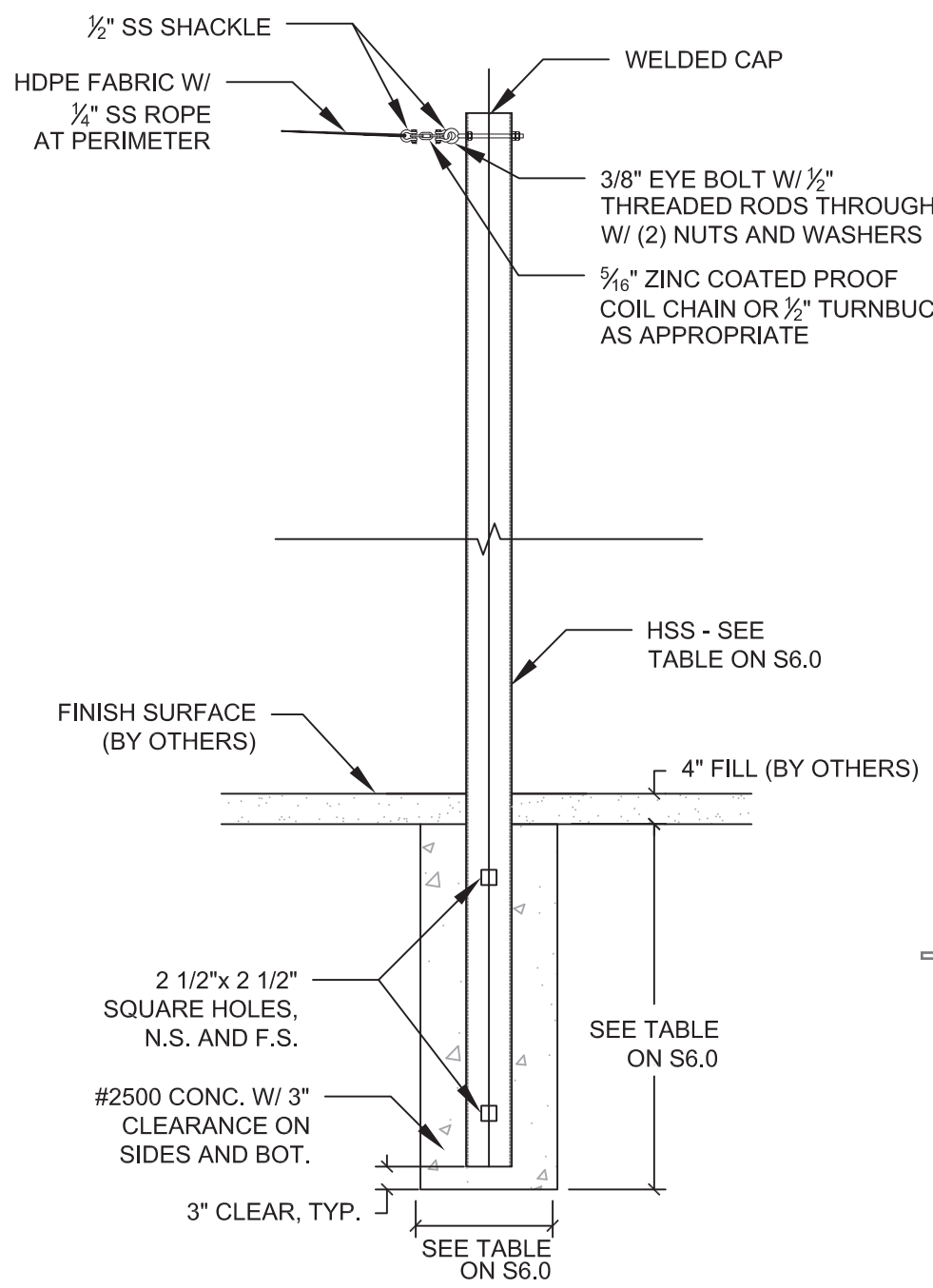

1a  
 S6.0  
 COLUMN & FOOTER DETAIL (SECTION)  
 1/2" = 1"

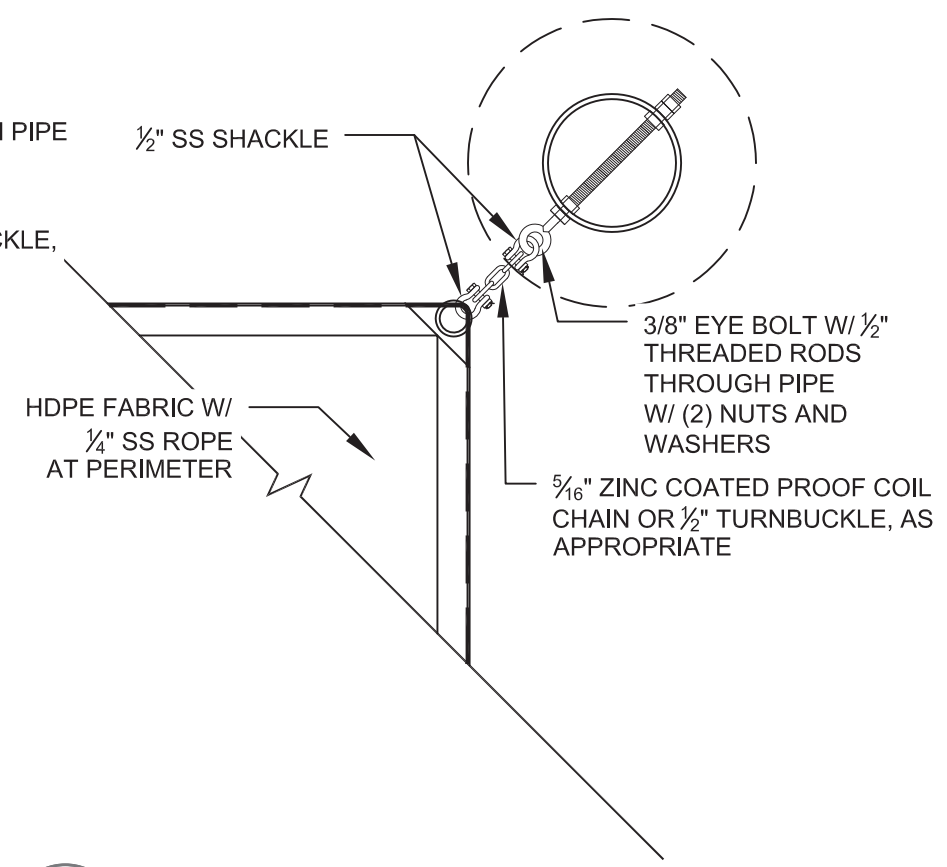

1b  
 S6.0  
 CONNECTION DETAIL (PLAN)  
 1" = 1"

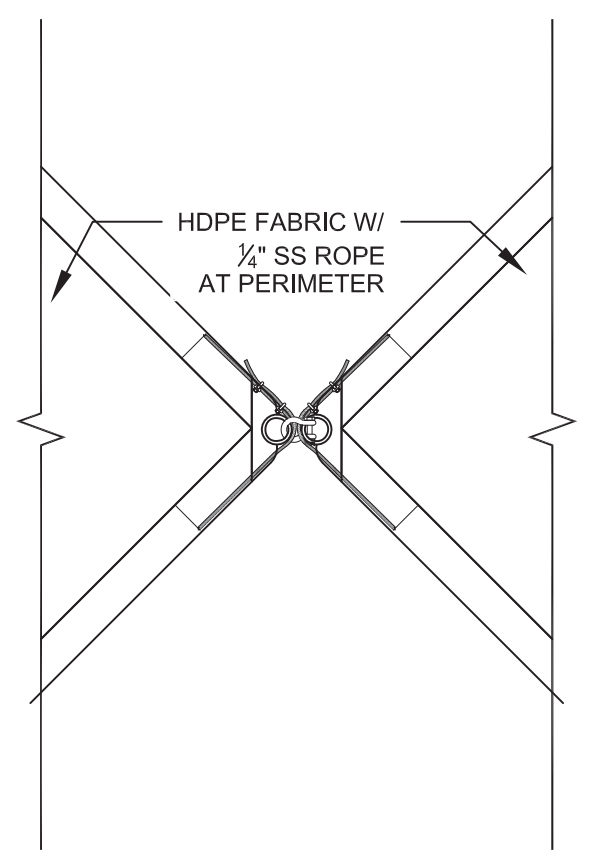

2  
 S6.0  
 CONNECTION DETAIL (PLAN)  
 1" = 1"

COLUMN & FOOTER DEPTH TABLE						
COL.	HSS SIZE	ALT. HSS SIZE	HEIGHT	24"Ø	30"Ø	36"Ø
1	6" SCH. 80		12'-2"	X'-X"	X'-X"	X'-X"
2	6" SCH. 80		12'-2"	X'-X"	X'-X"	X'-X"
3	6" SCH. 40		8'-2"	X'-X"	X'-X"	X'-X"
4	6" SCH. 80		12'-2"	X'-X"	X'-X"	X'-X"
5	6" SCH. 80		12'-2"	X'-X"	X'-X"	X'-X"
6	6" SCH. 40		8'-2"	X'-X"	X'-X"	X'-X"

NOTE: INSTALLER TO DETERMINE BEST FOOTER OPTION  
 BASED ON SITE CONDITIONS.

Date: 05/01/2017  
 DETAILS

**BOYS & GIRLS CLUB PAL ESCONDIDO**  
 PLAY STRUCTURE SHADE SAIL  
 115 WOODWARD AVENUE  
 ESCONDIDO, CA 92025

**S6.0**